

Adorn Mortarless Stone Veneer Installation

Natural Concrete Products – www.naturalconcreteproducts.com

Adorn Mortarless Stone Veneer can be used on new or existing construction. Adorn is nailed or screwed onto the wall; therefore no brick ledge is required. Adorn is limited to a height of 30ft with normal building design. Heights may be increased when specified by a structural engineer and approved by building officials. When a section of wall wraps over the top of the roof, this is called a “floater”. Extra support is needed in this area prior to the installation of Adorn.

Tools needed to install:

Safety glasses, gloves, ear plugs, dust mask, drill, saw with masonry blade, measuring tape, caulking gun, level, utility knife, hammer, proper sized screws or nails. Fasteners must be corrosion resistant with a 3/8” minimum head diameter and 1/8” shank. The length will vary and needs to be able to penetrate the studs to a depth of 1”. Natural Concrete Products (NCP) recommends the use of quality, exterior construction nails or screws. NCP is not responsible for the corrosion resistance of fasteners. Treated lumber may react with metal or coating of fastener. Determine compatibility when selecting fasteners.

Safety first is the number one priority with any construction project. Always wear safety glasses and gloves when handling Adorn. Cutting is often a key part of installation. You can either use a chop saw, circular saw, wet or dry saw, or a grinder with a diamond blade. Take all necessary precautions when cutting, use safety glasses, gloves, and dust mask.

Adorn Veneer Installation:

Adorn is designed to install over 7/16” or greater OSB or plywood sheathing attached to wood or metal studs. Two layers of code approved weather resistive barrier (WRB) must be installed for exterior installation. Typical WRB’s are Grade D building paper or #15 felt. Housewrap may be used as inner layer. All wall penetrations, doors, and windows, should be sealed using self-adhesive flashing properly wrapped and lapped per the flashing manufacturer’s instructions. If treated wood is used, use 30lb felt or building paper. The factory edge of Adorn panels should be used in all areas where the edge is visible.

Start installing the Adorn panels at the bottom checking for level after each course is installed (make adjustments to level if necessary). Hint: Securing a level 2X4 to the bottom of the structure will help getting the base row of panels level. Then remove the 2X4 after the installation. When placing the siding panels on the wall, each seam on the lower course must be overlapped by a minimum of 3” on each side of the seam by the upper course (see Fig 1). Cutting may be required. Corners must also be staggered (see Fig 2). Each siding piece is installed using 3 fasteners and must have at least one of its fasteners attached to a stud to a depth of 1”. The fasteners should be placed 1” above the veneer.

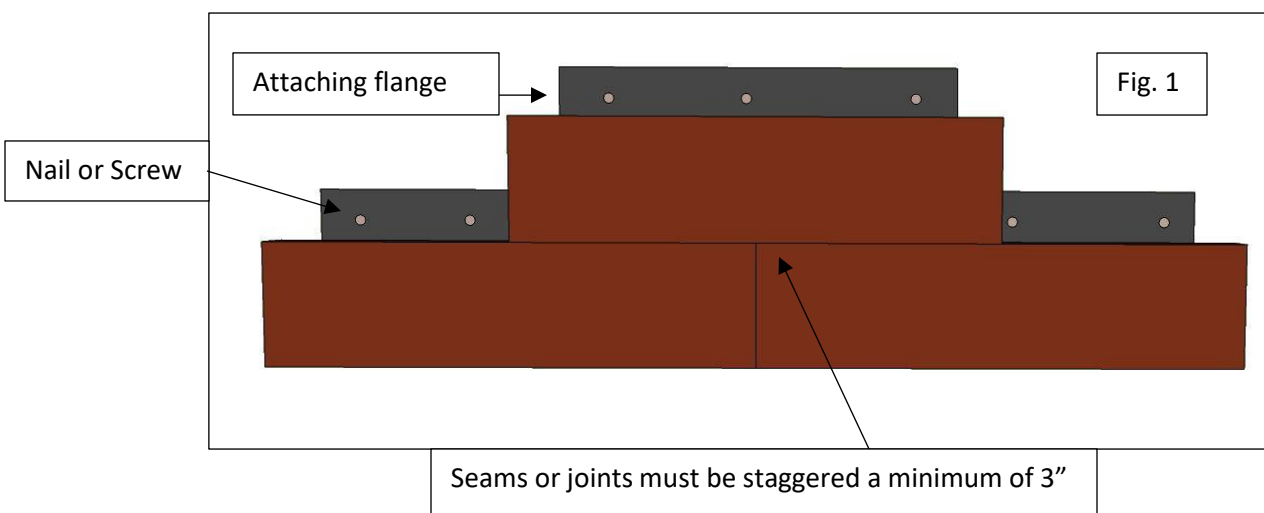

If the project requires corners, install the corner first and work out both sides. Corners should be installed with each course. Each corner piece needs two screws or nails to securely attach. Inside corners use the same corner pieces reversed.

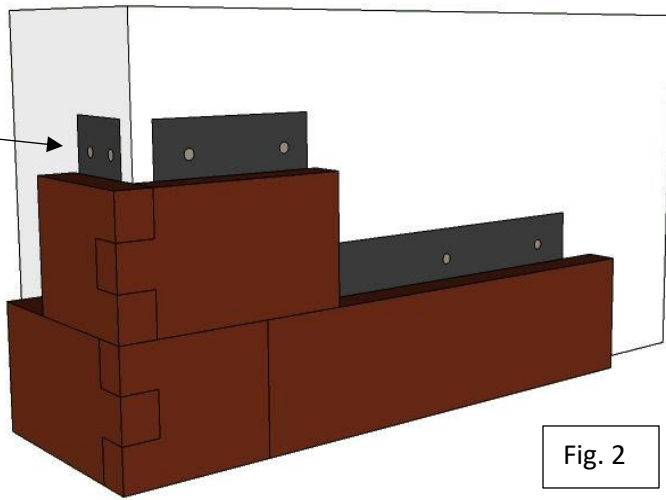
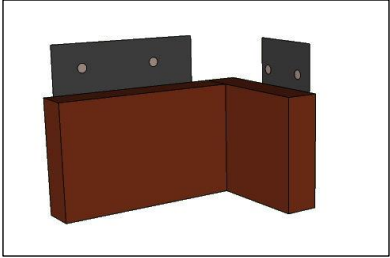
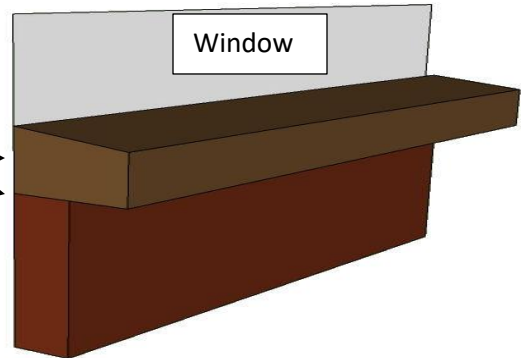

Fig. 2

During the installation, some panels will need to be cut to fit and the attaching flange will need to be removed. To remove the flange, carefully cut off with snips. This may produce sharp edges so handle with care. Pieces without the attaching flange will need to be installed with adhesive. In order to achieve a good bond, a non-painted, clean flashing material must be attached to the structure first. After the bonding surface has been installed, use a heavy duty construction adhesive such as PL Premium or DAP DynaGrip Max to install the Adorn pieces. Additional temporary support may be needed until adhesive cures.

To install a sill under a window, carefully remove the attaching flange and glue with a heavy duty construction adhesive. Place adhesive to the back and the bottom of the sill piece being installed.



Our product is designed to allow natural movement that protects from freezing, thawing, and settling. If you use adhesive on the Adorn panels, only place in the noted area to allow for drainage.

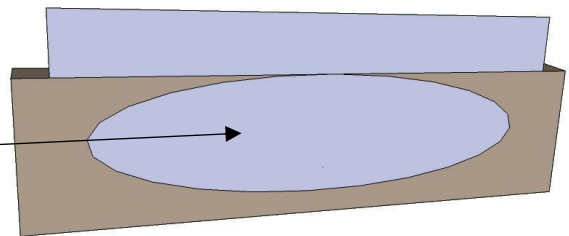

For applications where the Adorn system will terminate without a corner return, one suggestion is to have the Adorn veneer extend past the structure the width of the siding, corner trim, J channel, etc, on the return. For a finished look, place the panels with the factory edge exposed. The sills are installed the same as the panels with a minimum of 3 fasteners with 1 of these into a stud to a depth of 1".

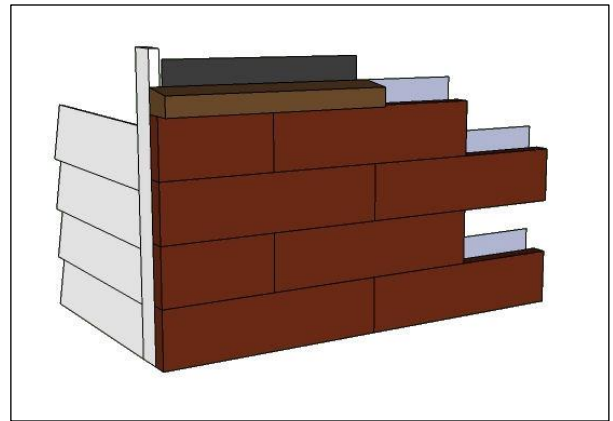

To finish projects where Adorn is to be installed up to the soffit, measure the distance from the last full panel installed to the soffit. Cut Adorn panels to fit and glue into place using construction adhesive, such as PL Premium or Dap DynaGrip. You may need to trim the attaching flange from the last full panel or securely attach a nonpainted, clean flashing material to the structure to achieve a good bond surface.

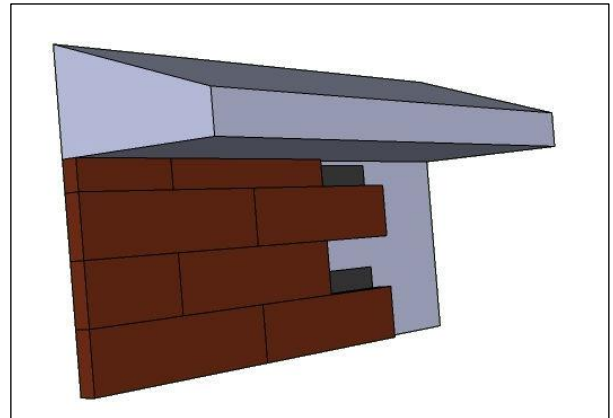

Important information:

Ensure that Adorn is being installed to a structure that meets all building code requirements. Code approved flashing must be used at all terminations, penetrations, and material transitions. Control moisture penetration caused by run off, gutters, and downspouts. If there is any question as to the integrity of the structure, contact the appropriate professional to correct. Adorn should maintain a 2" clearance from hard surfaces such as pavement and patio surfaces.

When cutting, grinding, or trimming any Adorn pieces, always follow the tool manufacturer's safety instructions and use the appropriate safety protection.

Cutting dust and general construction dust can be removed with clean water and if needed, a nylon bristle brush. Do not clean with a power washer, harsh chemicals, or acid products.

The small side of the corner occasionally may not fit as snug as desired. If needed, a dab of construction adhesive can be applied to the back of the piece to ensure a snug fit.

The corners are manually checked to fit together and are packaged as a set. There are 4 sets placed in the box together and the remaining 2 sets have the 5.5" pieces at one end of the box with the 2 9.5" pieces lying flat on the top. When installing corners, use the sets as they are shipped.

Adorn / Rust-Oleum coordinating colors to touch up the base color:
Colorado Gray - #249279 Primer Gray Desert Tan - #7772 Putty

Northern Gray - #249279 Primer Gray Terra - #249857 Satin London Gray

Buckskin - #7226 Bronze

Adorn Pillar Stone Installation

Natural Concrete Products – www.naturalconcreteproducts.com

Tools needed to install:

Safety glasses, gloves, measuring tape, caulking gun, level, exterior construction screws and construction adhesive. Safety first is the number one priority with any construction project. Always wear safety glasses and gloves when handling Adorn Pillar Stone.

Construct the pillar base using 2" X 2"s and OSB or plywood to the desired height. Each Pillar Stone is 6" high so designing the height in 6" increments will eliminate cutting of the Pillar Stones. The outside dimensions need to be 14" X 14". Cover the frame with an ice and water resistant type of wrap. It is recommended to use treated lumber (2"X4") on the base. Anchor the pillar as needed.

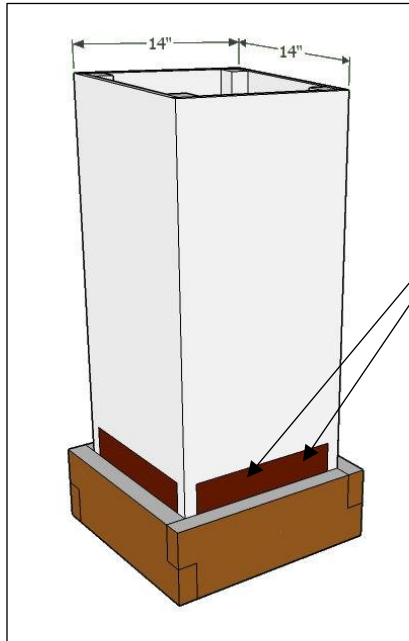

Attach the base course:

Place 4 Pillar Stones around the base as shown. Level the base course and attach with 2 screws per Pillar Stone through the attaching flange approximately 1" above the stone veneer. Continue installing the Pillar Stones one course at a time. Square up the corners, check for level and attach with screws.

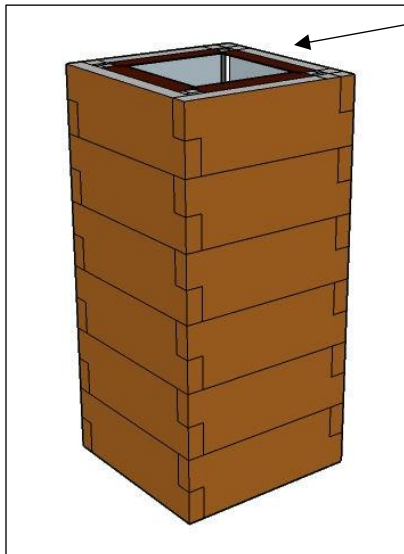

When you get to the top course, bend the flashing over the frame and screw in place.

Place a bead of construction adhesive around the top of the Pillar Stones. Set the Pillar Cap in place.

The finished pillar will be approximately 18" square.

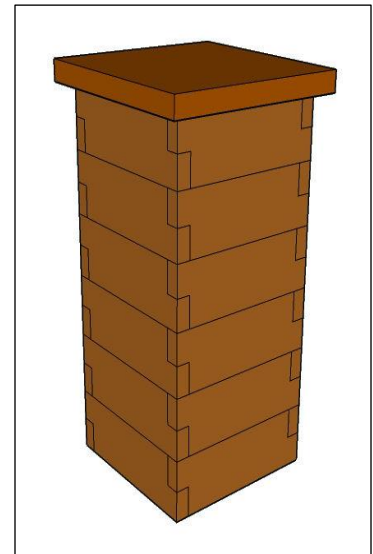

Adorn Post Stone Installation

Natural Concrete Products – www.naturalconcreteproducts.com

Adorn Post Stone is designed to fit on a 6" X 6" post.

When using treated wood, a layer of a peel & stick rubberized asphalt membrane must be used, like ProtectoWrap Deck Joist tape, or equivalent. The fastener used must be rated to be used on treated wood, GRK R4, U2 Universal, or equivalent.

Tools needed to install:

Safety glasses, gloves, measuring tape, caulking gun, level, proper screws and construction adhesive. Safety first is the number one priority with any construction project. Always wear safety glasses and gloves when handling Adorn Post Stone.

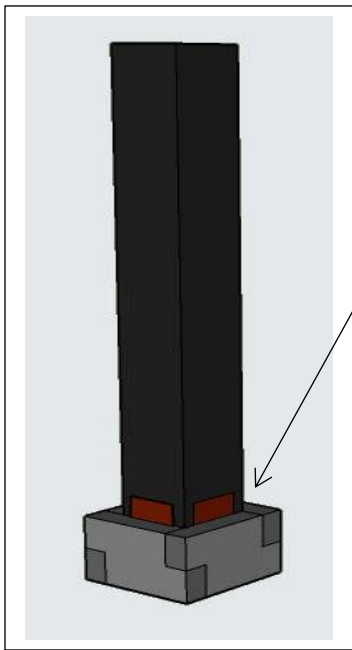

Attach the base course:

Place 4 Post Stones around the base of the 6" X 6" post as shown. Level the base course and attach with 2 screws per Post Stone through the attaching flange approximately 1" above the stone veneer. Continue installing the Post Stones one course at a time. Square up the corners, check for level, and attach with screws. Place a small dab of adhesive on the back of each stone approximately 1" from the bottom and adhere to the attaching flange of the piece below.

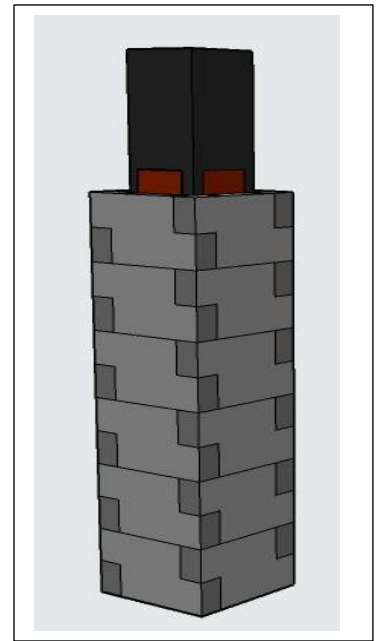

Natural Concrete Products (NCP) warrants Adorn for 30 years to the original consumer purchaser. This warranty covers manufacturing defects and covers the replacement cost of materials only, labor is not included. This warranty does not cover improper application, minor chipping, or minor cracks that do not affect the proper placement or impair the strength of the product. Adorn products are not warranted against discoloration due to normal weathering, air pollution, or chemicals. NCP is not responsible for the corrosion resistance of fasteners.